

## TECHNICAL INFORMATION SHEET

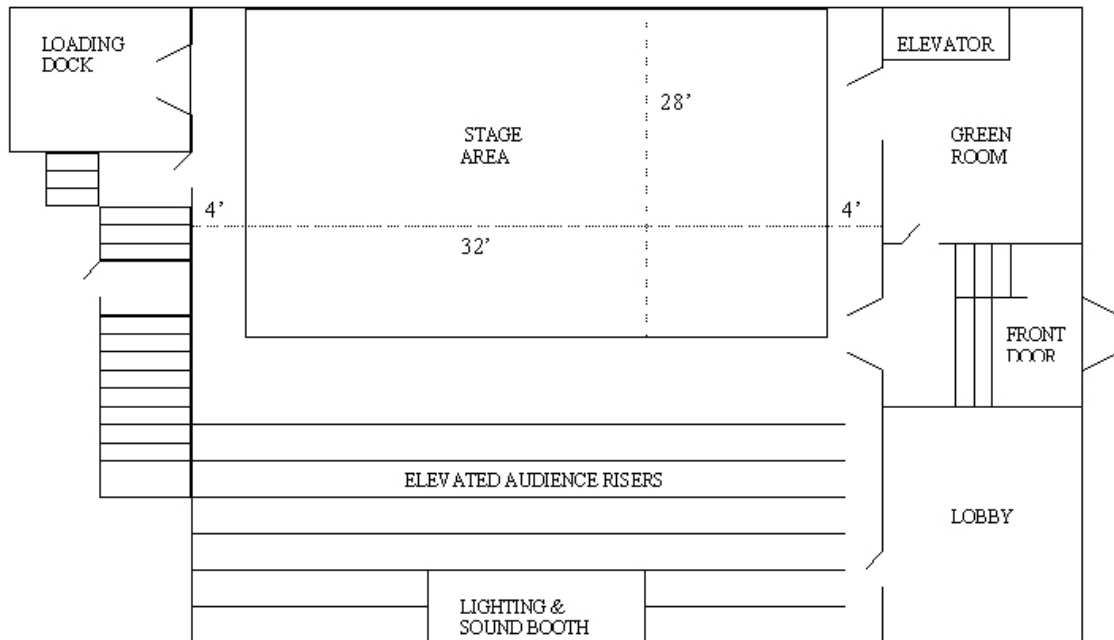

Seating capacity: 150

This type of facility is a black-box theatre built to accommodate a wide variety of performing arts events. The theatre space is suitable for literary readings, workshops, lectures and demonstrations, theatrical productions, small musical groups, and dance events.



Not to scale

## Registry Theatre Equipment –Jan, 2018

### STAGE INFORMATION

Type - Proscenium  
Width – 32'  
Depth – 28'  
SPRUNG FLOOR  
Crossover – 3' US of Traveller

### CEILING HEIGHT

14' 6" to grid,  
12' to DS bulkhead

### DRAPES

Main Traveller,  
manual pull SL  
MIDLINE traveller Pull SL  
(upon request)  
Back Traveller,  
manual pull SL  
LEGS - 6, (can pivot from  
standard Italian to German to  
Dance formation).

### DRESSING ROOMS

Green Room, upstairs  
Yellow Room, basement  
LOADING DOCK  
Location, stage right

### SEATING

Total chairs– 150  
With extra front row- 166  
(MUST NOT exceed 17 chairs  
Per row)

### FIRE EXITS

Through Main Entrance  
2.- Through Stage Right  
(no props storage in this exit—  
MUST remain clear)

### LIGHTING

**STANDARD HOUSE PLOT**  
includes the following:

6 – 575w 50 degree source 4s

6 – 750w 6" Fresnel (at tops)

6 – 575w source 4 wide par  
(as sides)

### LIGHTING CONTROL

Location – booth, rear of  
House

**CONTROL ETC ELEMENT**  
(EOS family compatible)

47 ceiling circuits  
48 - 2kw dimmers (1 dimmer  
used for houselights.

Asst lengths of 20Atwist

Asst Twofers and adapters to  
Uground

### Additional RENTABLE lighting fixtures

6-50deg S-4 575w  
10- S-4 pars 575  
8x 750 fresnel  
6x 500w fresnel

6 x Century 2321 6x12  
12 Century 2321 6x9

9x24-36deg Parallipspheres  
7x 6x12 Parallipspheres  
14x 6x9 parallipspheres  
Most at 750 watt.

Various other older working  
fixtures available upon request

ADDITION INTELLIGENT  
LIGHTING includes....

3 x I-Cues on 19deg S4  
at FOH  
15 x scrollers on FOH, Tops  
and I-Cues  
12x TRX colour Blasts  
(6 tips, 6 floats)

See detailed Excel sheet  
available upon request

### SOUND EQUIPMENT

MIXING CONSOLE  
Allen and Heath Zed428

24 mic inputs, 2 stereo  
channels, 6 AUX out (2 pre, 2  
pre/post, 2 post)

Onstage inputs, 24/6trns  
16/4 @ UC, 8/2@ DL

Peavy 31 Band EQ—locked

AMPLIFIERS  
EV – 2 stereo

FOH SPEAKERS  
2 – Main EV  
15-Inch Two-Way  
90° x 50°, 600W  
2 – EV Side Fill  
8" Two-Way,  
90° x 50° 200W

EV Powered Sub (2 SL)

CD PLAYERS IN RACK  
2 Denon  
1 MP3 jack on snd desk

DVD Player (not Blu-ray/HD)

Telephone Jack from SMdesk  
to upstage wall

### Additional, RENTABLE AV Equipment.

### MICROPHONES

4 - SM57  
6-- SM58  
1 SM58 Wireless HH  
2 x Rode NT5 Cond  
1x Rode NT4 Stereo Cond  
4x Senn 935e

10 boom stands.

### MONITORS

4 x EV ZLX12" active monitor  
2x 16" EON active  
2x 10" Peavey active

-Behringer 4ch  
Compressor  
-DEP5 FX/Rev unit

6x passive DI box  
1 xstereo passive DI Box

Sundry Xlr Cables  
50' 12x4 snake.

### PIANOS

-Yamaha 5'8" C-2  
Concert Grand  
- digital piano –  
Technics SX-PR51

**INTERCOM SYSTEM** 6  
headset/beltpacks

### PROJECTION EQUIPMENT

Multimedia Projector  
Canon LV-7365  
VGA locations @ booth and  
DSL

Projection Screen, 15'x15'  
located behind US traveller

Cyc, located behind US  
traveller